

UNCONTROLLED DOCUMENT

PART NUMBER
OED-RM220-5F

REV.
B

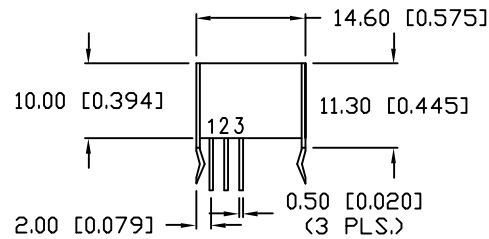
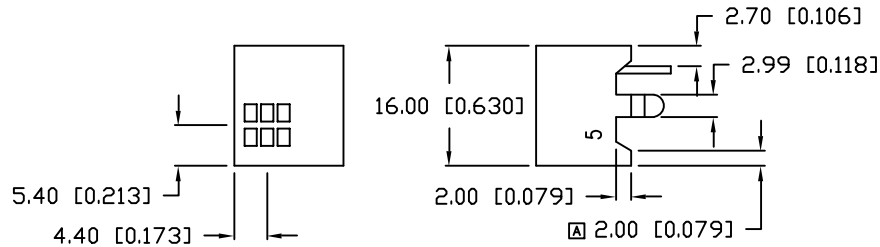

PANEL CUTOUT

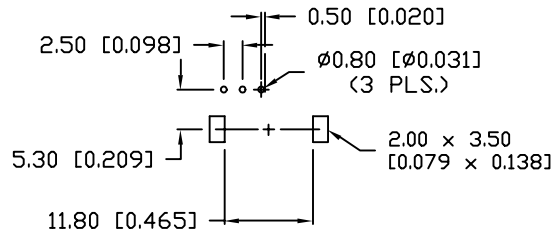

NOTES: ①

1. OUTPUT
2. Vcc
3. GND

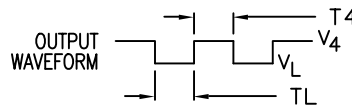
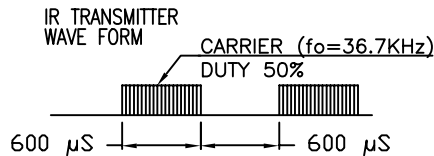
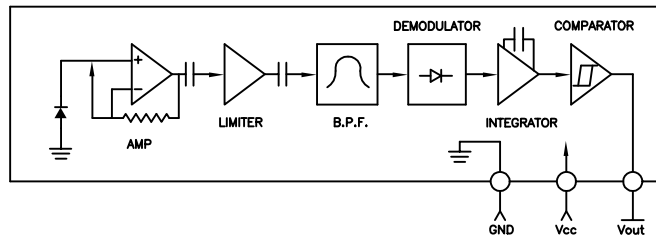

ELECTRO-OPTICAL CHARACTERISTICS $T_A=25^\circ\text{C}$

PARAMETER	SYMBOL	MIN	TYP	MAX	UNITS
SUPPLY VOLTAGE	Vcc		5		V
SUPPLY CURRENT	Icc	-	-	3	mA
DETECTING DISTANCE	L	10	-	-	m
HALF ANGLE	θ	-	± 45	-	DEG
B.P.F. CENTER FREQUENCY	fo	-	36.7	-	KHz
PEAK WAVELENGTH	p	-	940	-	nm
HIGH LEVEL OUTPUT VOLT.	Voh	Vcc	-	-	V
LOW LEVEL OUTPUT VOLT.	Vol	-	-	0.45	V
HIGH/LOW LVL. PULSE WIDTH	TH/TL	440	-	770	μS

LIMITS OF SAFE OPERATION AT 25°C

PARAMETER	UNITS	RATING	UNITS
SUPPLY VOLTAGE	Vcc	6.3	V
SUPPLY CURRENT	Icc	3	mA
OUTPUT VOLTAGE	Vout	6.3	V
OPERATING TEMP.	T _{op}	-40 TO +60	°C
STORAGE TEMP.	T _{str}	-20 TO +75	°C
SOLDERING TEMP.	T _{sol}	+260	°C
2.0mm FROM BODY			3 SEC. MAX

*TOLERANCES PER DECIMAL PRECISION ARE: X=±1 (±0.039), X.X=±0.5 (±0.020), X.XX=±0.25 (±0.010). LEAD LENGTH=±0.75 (±0.030). MIN= +DECIMAL PRECISION MAX.= +0.00 -DECIMAL PRECISION

UNCONTROLLED DOCUMENT

REV.
B

PART NUMBER
OED-RM220-5F

CONFIDENTIAL INFORMATION
THE INFORMATION CONTAINED IN THIS DOCUMENT IS THE PROPERTY OF LUMEX INC. EXCEPT AS SPECIFICALLY AUTHORIZED IN WRITING BY LUMEX INC., THE HOLDER OF THIS DOCUMENT SHALL KEEP ALL INFORMATION CONTAINED HEREIN CONFIDENTIAL AND SHALL PROTECT SAME IN WHOLE OR IN PART FROM DISCLOSURE AND DISSEMINATION TO ALL THIRD PARTIES.

LUMEX
INCORPORATED

290 E. HELLEN ROAD
PALATINE, ILLINOIS 60067
PHONE: (847) 359-2790
WEB: <http://www.lumex.com>

REMOTE CONTROL RECEIVER MODULE,
WITH POWER SUPPLY NOISE FILTER.

RELIABILITY NOTE
OUR MANY YEARS OF EXPERIENCE DATA ACCUMULATION INDICATE THAT SOLDER HEAT IS A MAJOR CAUSE OF EARLY AND FUTURE FAILURE. PLEASE PAY ATTENTION TO YOUR SOLDERING PROCESS.

DRAWN BY: TM/BC	CHECKED BY:	APPROVED BY:	DATE: 3-3-97
			PAGE: 1 OF 1
			SCALE: N/A